

	DIMENSIONS	SQUARE FOOTAGE	BANQUET 72"	CLASSROOM	THEATER	RECEPTION	CONFERENCE
<b>LEVEL TWO</b>							
JUNIOR BALLROOM	158'X95'	15,050	1,100	1,000	1,500	1,300	—
JUNIOR BALLROOM 1	52'X31'	1,675	100	75	130	100	32
JUNIOR BALLROOM 2	52'X31'	1,675	100	75	130	100	32
JUNIOR BALLROOM 3	52'X31'	1,667	100	75	130	100	32
JUNIOR BALLROOM 4	52'X95'	5,026	350	340	550	400	—
JUNIOR BALLROOM 5	52'X31'	1,675	100	75	130	100	32
JUNIOR BALLROOM 6	52'X31'	1,675	100	75	130	100	32
JUNIOR BALLROOM 7	52'X31'	1,667	100	75	130	100	32
MEETING ROOM 1	83'X30'	2,496	180	130	260	200	—
MEETING ROOM 2	25'X30'	779	40	35	65	60	16
MEETING ROOM 3	27'X30'	819	50	40	70	65	18
MEETING ROOM 2 & 3	52'X30'	1,598	100	75	120	100	30
MEETING ROOM 4	27'X30'	819	50	40	70	65	18
MEETING ROOM 5	36'X30'	1,090	60	50	90	70	22
MEETING ROOM 4 & 5	63'X30'	1,909	110	100	145	110	30
LEVEL TWO PREFUNCTION	—	18,114	1,200	—	—	1,500	—

### LEVEL FOUR

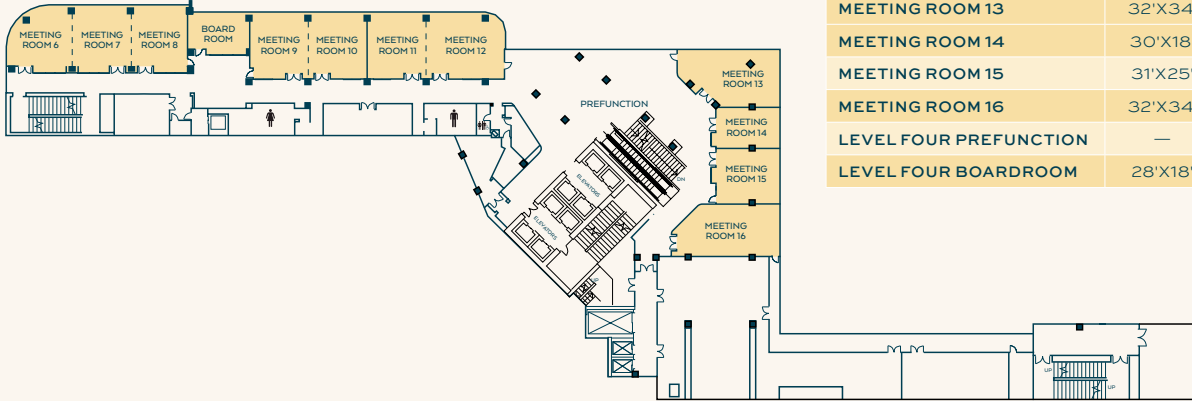

	DIMENSIONS	SQUARE FOOTAGE	BANQUET 72"	CLASSROOM	THEATER	RECEPTION	CONFERENCE
<b>LEVEL FOUR</b>							
MEETING ROOM 6	29'X30'	897	50	46	75	65	20
MEETING ROOM 7	27'X30'	836	50	40	70	65	18
MEETING ROOM 6 & 7	56'X30'	1,733	100	80	135	100	34
MEETING ROOM 8	25'X30'	787	40	35	65	60	16
MEETING ROOM 7 & 8	52'X30'	1,623	100	75	120	100	30
MEETING ROOM 6, 7 & 8	81'X30'	2,520	170	130	250	170	50
MEETING ROOM 9	27'X30'	817	50	40	70	65	18
MEETING ROOM 10	27'X30'	819	50	40	70	65	18
MEETING ROOM 9 & 10	54'X30'	1,636	100	75	120	100	30
MEETING ROOM 11	27'X30'	819	50	40	70	65	18
MEETING ROOM 12	36'X30'	1,086	60	50	90	70	22
MEETING ROOM 11 & 12	63'X30'	1,905	110	100	145	110	38
MEETING ROOM 13	32'X34'	1,088	60	48	80	70	22
MEETING ROOM 14	30'X18'	556	30	28	50	40	12
MEETING ROOM 15	31'X25'	805	50	40	70	65	18
MEETING ROOM 16	32'X34'	1,088	60	48	80	70	22
LEVEL FOUR PREFUNCTION	—	7,214	—	—	—	—	—
LEVEL FOUR BOARDROOM	28'X18'	529	30	28	50	40	12

## LEVEL SIX

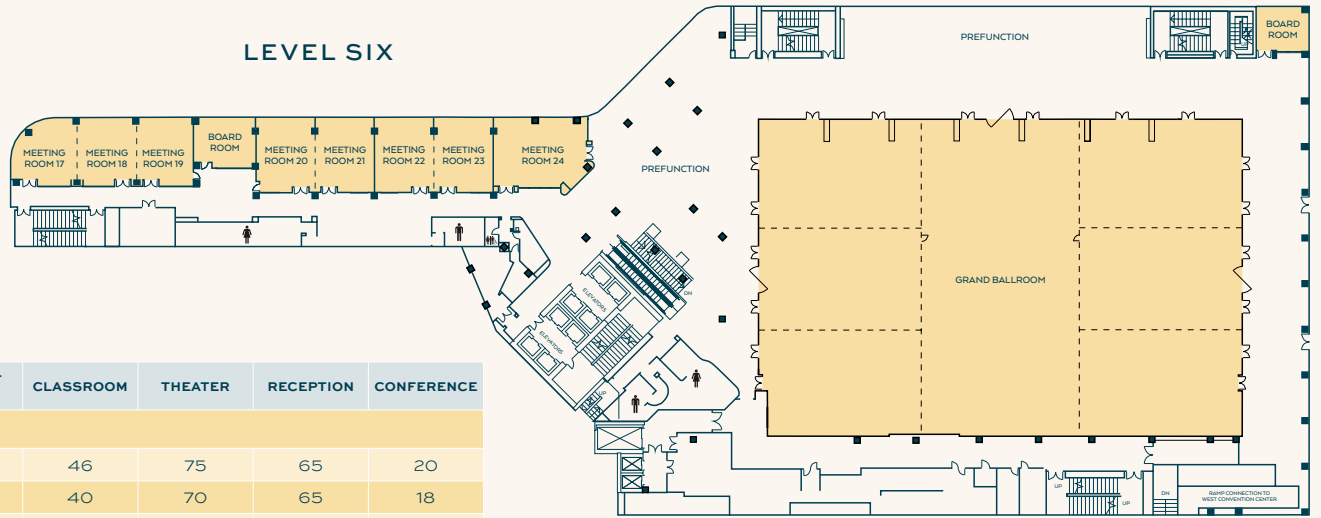

	DIMENSIONS	SQUARE FOOTAGE	BANQUET 72"	CLASSROOM	THEATER	RECEPTION	CONFERENCE
<b>LEVEL SIX</b>							
MEETING ROOM 17	29'X30'	897	50	46	75	65	20
MEETING ROOM 18	27'X30'	836	50	40	70	65	18
MEETING ROOM 17 & 18	56'X30'	1,733					
MEETING ROOM 19	25'X30'	785	40	35	65	60	16
MEETING ROOM 18 & 19	52'X30'	1,621					
MEETING ROOM 17, 18 & 19	81'X30'	2,518					
MEETING ROOM 20	27'X30'	817	50	40	70	65	18
MEETING ROOM 21	27'X30'	822	50	40	70	65	18
MEETING ROOM 20 & 21	54'X30'	1,639					
MEETING ROOM 22	27'X30'	822	50	40	70	65	18
MEETING ROOM 23	27'X30'	819	50	40	70	65	18
MEETING ROOM 22 & 23	54'X30'	1,641					
MEETING ROOM 24	43'X31'	1,275	80	65	100	80	24
GRAND BALLROOM	215'X142'	30,816	2,400	2,200	3,500	3,000	—
GRAND BALLROOM 1	71'X46'	3,359	220	210	380	220	54
GRAND BALLROOM 2	71'X46'	3,359	220	210	380	220	54
GRAND BALLROOM 3	71'X46'	3,359	220	210	380	220	54
GRAND BALLROOM 4	71'X142'	10,080	650	640	1,100	650	—
GRAND BALLROOM 5	71'X46'	3,359	220	210	380	220	54
GRAND BALLROOM 6	71'X46'	3,359	220	210	380	220	54
GRAND BALLROOM 7	71'X46'	3,379	220	210	380	220	54
LEVEL SIX PREFUNCTION	—	26,206	2,100	—	—	2,600	—
LEVEL SIX BALLROOM	22'X20'	455	30	28	45	35	10
BALLROOM PATIO	120'X29'	3,562	290	—	—	350	—