

Meetings & Event Guide.

OMNI LOS ANGELES HOTEL
AT CALIFORNIA PLAZA



EXPERIENCES MATTER HERE



OMNI
LOS ANGELES



Congregate and collaborate IN DTLA.

Sitting atop Bunker Hill, Omni Los Angeles Hotel at California Plaza is located at the heart of DTLA. Welcome meeting attendees and event guests to connect at the creative epicenter of California.

Design the ultimate meeting or event across over 20,000 square feet of flexible indoor and outdoor function space. Four new distinct outdoor spaces welcome you to make the most of Los Angeles' famously sunny weather. Whether you're organizing an intimate gathering or a grand gala, our versatile spaces are designed to meet your needs. Exclusive to Omni Los Angeles Hotel, these unique outdoor venues provide the perfect oasis in the heart of Angel City.



about
Omni Los Angeles Hotel
at California Plaza.

DOWNTOWN ELEGANCE AND SOCIAL STYLE

Inviting guest rooms are designed with contemporary style, most featuring views of the LA skyline. An outdoor heated lap pool invites you to enjoy SoCal weather year-round and an on-site restaurant offering the best of Californian cuisine.



- 453 spacious guest rooms with views of Bunker Hill or California Plaza Watercourt
- 20,000 square feet of flexible indoor and outdoor meeting, event and pre-function space, including the 8,520 square foot Bunker Hill Ballroom and nine war rooms
- Four distinct outdoor event spaces including NOÉ Terrace with dramatic cityscape view, MOCA Terrace adjacent to the pool deck with views of the MOCA Museum, The Plaza lined with mature trees and the expansive Yard with built-in stage, amphitheater seating and space for up to 3,000 guests
- Fast Wi-Fi, the latest AV technology and helpful professional services
- Outdoor heated lap pool and lounge area with fire pits
- Two unique bars and restaurants include NOÉ Restaurant & Bar with a seasonal California menu in a romantic setting and lunch and Stance Coffee Bar for fresh coffee, pastries and sandwiches
- A 1,500 square foot fitness center with weight training and cardio equipment

Flexible, Next Generation Event & Meeting Space.

LEVEL TWO

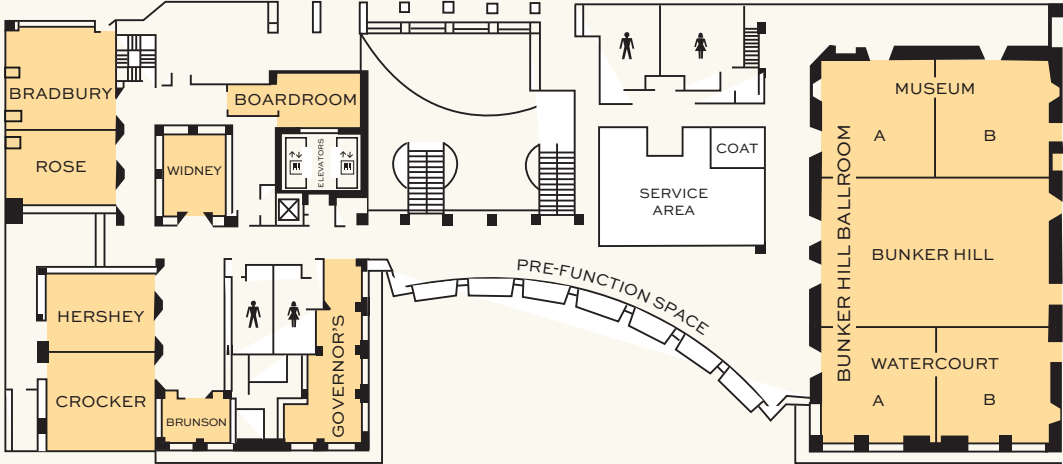

LEVEL FOUR

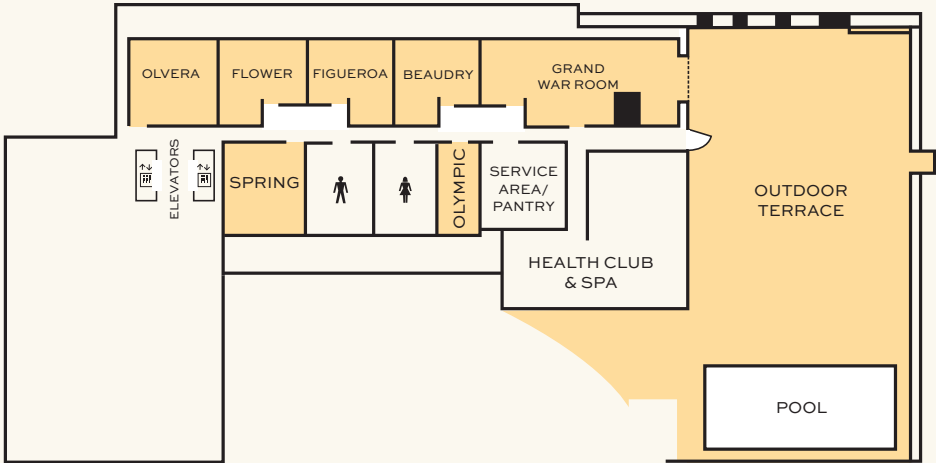

	SQUARE FOOTAGE	DIMENSIONS	CEILING HEIGHT	PORTABLE WALLS	THEATER	CLASSROOM	BANQUET	RECEPTION	CONFERENCE	U-SHAPE
SECOND FLOOR										
BUNKER HILL BALLROOM	8,520	71' x 120'	19'	YES	1000	450	850	1000	—	—
BUNKER HILL	3,266	71' x 46'	19'	YES	350	180	250	350	80	—
MUSEUM A	1,225	35' x 35'	14'	YES	110	50	90	110	40	27
MUSEUM B	1,225	35' x 35'	14'	YES	110	50	90	110	40	27
MUSEUM A & B	2,485	71' x 35'	14'	YES	220	100	180	220	80	54
BUNKER HILL/MUSEUM A & B	5,751	71' x 81'	19'/14'	YES	570	280	430	570	160	54
WATERCOURT A	1,260	35' x 36'	14'	YES	110	50	90	110	40	27
WATERCOURT B	1,260	35' x 36'	14'	YES	110	50	90	110	40	27
WATERCOURT A & B	2,556	71' x 36'	14'	YES	220	100	180	220	80	54
BUNKER HILL/WATERCOURT A & B	5,822	71' x 82'	19'/14'	YES	570	280	430	570	160	—
BRADBURY	1,122	34' x 33'	12'	YES	70	40	60	70	30	25
ROSE	825	25' x 33'	12'	YES	60	35	50	60	25	22
BRADBURY/ROSE	1,947	59' x 33'	12'	YES	150	90	140	150	55	45
HERSHEY	936	26' x 36'	12'	YES	60	35	50	60	25	22
CROCKER	1,044	29' x 36'	12'	YES	70	40	60	70	30	25
HERSHEY/CROCKER	1,980	55' x 36'	12'	YES	150	90	140	150	55	45
GOVENOR'S	702	26' x 27'	12'	NO	40	18	40	40	25	18
WIDNEY	456	19' x 24'	12'	NO	40	18	30	40	20	—
BOARDROOM	450	25' x 18'	12'	NO	—	—	—	—	18	—
BRUNSON	350	25' x 14'	12'	NO	—	—	—	—	12	—
FOURTH FLOOR										
GRAND WAR ROOM	792	33' x 24'	8'	NO	—	—	—	—	—	—
BEAUDRY	551	29' x 19'	8'	NO	40	24	30	40	20	20
FIGUEROA	551	29' x 19'	8'	NO	40	24	30	40	20	20
FLOWER	551	29' x 19'	8'	NO	40	24	30	40	20	20
OLVERA	551	29' x 19'	8'	NO	40	24	30	40	20	20
SPRING	551	29' x 19'	8'	NO	40	24	30	40	20	20
OLYMPIC	216	12' x 18'	8'	NO	20	—	10	20	10	—
OUTDOOR TERRACE	—	—	—	NO	—	—	—	—	—	—

Los Angeles *highlights.*

Explore the revitalized cultural hub that is downtown Los Angeles. World-class creative institutions like the Museum of Contemporary Art and Walt Disney Concert Hall sit beside towering skyscrapers and chic restaurants and boutiques. Explore legendary neighborhoods like Hollywood and Beverly Hills, with their leafy palms and aura of possibility.

AIRPORTS

Los Angeles International Airport | 15 miles

ATTRACTIONS

Angels Flight | 1 block

Los Angeles Civic Center, Los Angeles City Hall and courthouses | 3 blocks

Little Tokyo | 9 blocks

Los Angeles Convention Center | 10 blocks

Chinatown | 11 blocks

Olvera Street | 12 blocks

Koreatown | 12 min

TCL Chinese Theatre (Grauman's) | 20 min

Universal Studios Hollywood | 20 min

ARTS & CULTURE

Museum of Contemporary Art | adjacent

The Broad Museum | 1 block

Colburn School | 1 block

Los Angeles Music Center | 1 block

Los Angeles Opera | 1 block

Mark Taper Forum | 1 block

Walt Disney Concert Hall | 1 block

The GRAMMY Museum | 5 min

Natural History Museum of LA County | 4 miles

California Science Center | 4 miles

SPORTS

Crypto.com Arena, home of LA Lakers and NHL LA Kings | 5 min

Dodger Stadium, home of MLB LA Dodgers | 8 min

BMO Coliseum, home of Angel City Football Club | 10 min

Rose Bowl Stadium | 20 min

SoFi Stadium, home of the LA Rams | 24 min

Intuit Dome, home of the LA Clippers | 24 min

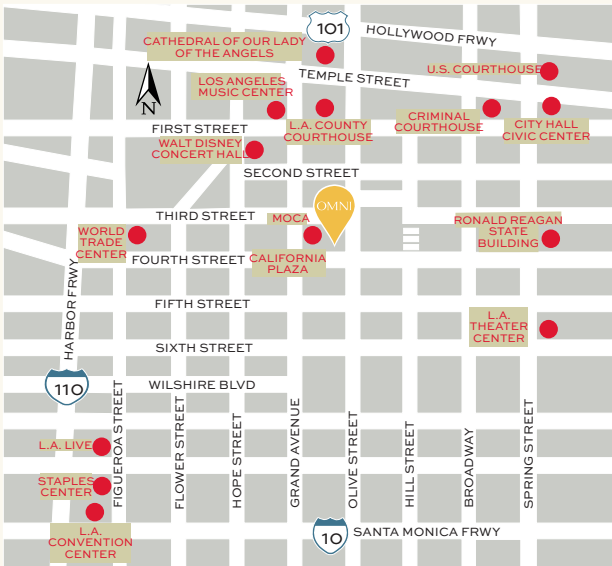

OMNI LOS ANGELES HOTEL AT CALIFORNIA PLAZA
251 SOUTH OLIVE STREET
LOS ANGELES, CALIFORNIA 90012

213.356.4099

LAXCTRLEADS@OMNIHOTELS.COM

