

Meetings & Event Guide.

OMNI OKLAHOMA CITY HOTEL



EXPERIENCES MATTER HERE



OMNI
OKLAHOMA CITY



Experience the Modern FRONTIER.

The Great Plains evoke visions of wide open spaces—and that's exactly what you'll find at Omni Oklahoma City Hotel. From floor-to-ceiling guest room windows with views of downtown and Scissortail Park to the spacious modern ballrooms, the hotel takes inspiration from the pastoral landscape of Oklahoma's terrain.

Genuine hospitality matters here. With over 76,000 square feet of meeting space adjacent to the new Oklahoma City Convention Center, Omni Oklahoma City Hotel is the ideal location for your next event. Our team of meeting professionals can help you plan everything from a private board meeting to a multi-day conference and everything in between.



about Omni Oklahoma City Hotel.

SOUTHERN WARMTH AND CONTEMPORARY COMFORT

With an entertainment and culinary-forward atmosphere and an authentic local feel, Omni Oklahoma City Hotel pays homage to the heritage and modern progress of the city. Lounge on the rooftop pool deck with unparalleled views of the city skyline. Dine at six distinct restaurants all day long, from morning coffee and pastries at Park Grounds to locally inspired evening cocktails at Basin Bar. Before checking out, shop for local gifts at Rarebird, a curated boutique that showcases the work of OKC creatives.



- 605 modern guest rooms, including 29 suites, inspired by the earthy tones of the southern landscape
- Approximately 76,000 square feet of flexible indoor and outdoor meeting, event and pre-function space, including the 20,500 square foot Oklahoma Station Ballroom, the 10,222 square foot Five Moons Ballroom and Scissortail Terrace overlook Scissortail Park
- Fast Wi-Fi, the latest AV technology and helpful professional services
- On-site UPS Store offering full service shipping and receiving. Located on the second floor
- A sleek, contemporary rooftop pool deck with fireplace, private cabanas and Catbird Seat pool bar, all overlooking Scissortail Park
- Six unique dining experiences including local craft beers and high-end wines at Basin Bar, nationally renowned Bob's Steak & Chop House, two-story sports bar OKC Tap House, retro-classic diner Seltzer's, coffee and espresso bar Park Grounds and poolside cocktails and light bites at Catbird Seat
- Head-to-toe treatments at full-service Mokara Spa, plus sauna, relaxation lounge and a private room available for group dining
- 24-hour fitness center includes Cybex weight machines, free weights, kettlebells, treadmills, ellipticals, Pelotons and more for a varied workout

Oklahoma City

highlights

Oklahoma City is divided into unique cultural districts, making it easy to find exactly the fun you're looking for. Bring the family to OKC's Adventure District to tour the Oklahoma City Zoo and National Cowboy & Western Heritage Museum. Sample delicious Asian fusion in the Asian District, home to a large Vietnamese community. Shop the boutiques of Automobile Alley, listen to live jazz in Deep Deuce and row on the Oklahoma River in the Boathouse District.

AIRPORT

Will Rogers World Airport | 14 min

ATTRACTIONS

Scissortail Park | across the street
Myriad Botanical Gardens & Crystal Bridge Tropical Conservatory | 2 blocks
Bricktown Entertainment District | 4 blocks
RIVERSPORT Adventures/RIVERSPORT Rapids | 3 min
Oklahoma City Zoo | 12 min

ARTS & CULTURE

Oklahoma City Museum of Art | 9 blocks
Oklahoma Contemporary Arts Center | 6 min
First Americans Museum (FAM) | 7 min
Paseo Arts District | 11 min
National Cowboy & Western Heritage Museum | 12 min

SPORTS

Paycom Center | across the street
Chickasaw Bricktown Ballpark, home of the minor league OKC Dodgers | 5 blocks

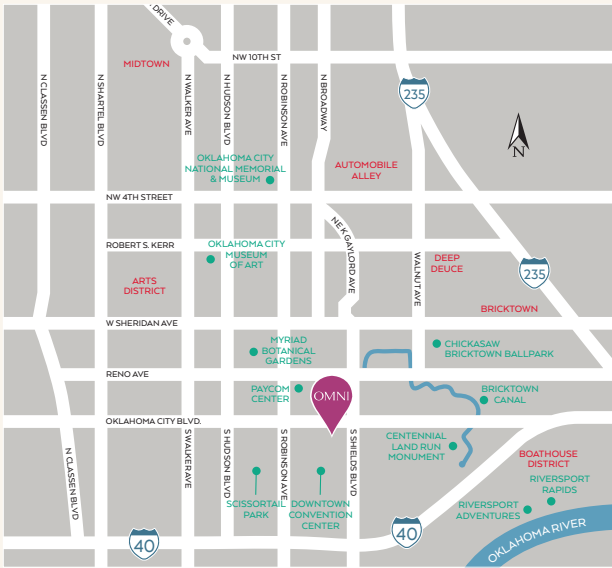

OMNI OKLAHOMA CITY HOTEL
100 W. OKLAHOMA CITY BLVD.
OKLAHOMA CITY, OKLAHOMA 73109
[OMNIHOTELS.COM/OKLAHOMACITY](https://omnihotels.com/oklahomacity)



Flexible, Next Generation Event & Meeting Space.

LEVEL TWO



LEVEL THREE

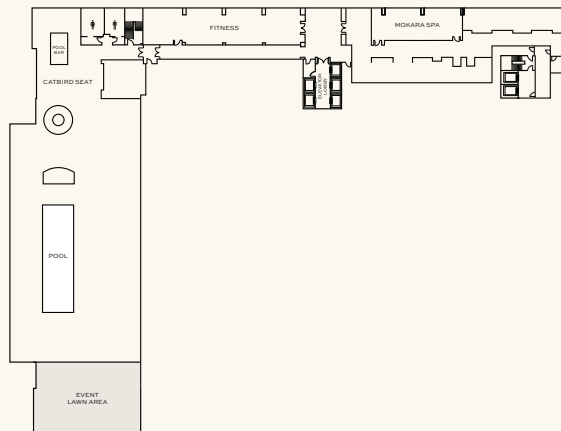

LEVEL 17

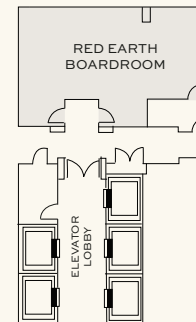

	DIMENSIONS	SQUARE FOOTAGE	CEILING HEIGHT	BANQUET 72"	CLASSROOM	U-SHAPE	THEATRE	RECEPTION	EXHIBIT 8'x10'
LEVEL TWO									
OKLAHOMA STATION BALLROOM	199'x103'	20,500	22'	1,530	1,404	-	2,208	2,050	120
OKLAHOMA STATION 1-3	103'x 49'6"	5,100	22'	320	342	108	550	510	29
OKLAHOMA STATION 1-4	103'x 99'6"	10,250	22'	810	684	-	1,104	1,025	61
OKLAHOMA STATION 4-5	103'x100'	10,300	22'	810	684	-	1,104	1,030	64
OKLAHOMA STATION 5-8	103'x 99'6"	10,250	22'	810	684	-	1,104	1,025	61
OKLAHOMA STATION 6-8	103'x 49'6"	5,100	22'	320	342	108	550	510	29
OKLAHOMA STATION 1	49'6" x 34'4"	1,700	22'	120	108	48	176	170	-
OKLAHOMA STATION 2	49'6" x 34'4"	1,700	22'	120	108	48	176	170	-
OKLAHOMA STATION 3	49'6" x 34'4"	1,700	22'	120	108	48	176	170	-
OKLAHOMA STATION 4	103'x50'	5,150	22'	360	342	108	550	515	32
OKLAHOMA STATION 5	103'x50'	5,150	22'	360	342	108	550	515	32
OKLAHOMA STATION 6	49'6"x34'4"	1,700	22'	120	108	48	176	170	-
OKLAHOMA STATION 7	49'6"x34'4"	1,700	22'	120	108	48	176	170	-
OKLAHOMA STATION 8	49'6"x34'4"	1,700	22'	120	108	48	176	170	-
OKLAHOMA STATION PREFUNCTION	-	11,036	16'	-	-	-	-	1,104	-
FIVE MOONS BALLROOM	132'4"x 77'3"	10,222	22'	720	663	-	1,122	1,022	56
FIVE MOONS 1-3	77'3"x33'2"	2,562	22'	180	180	75	285	256	14
FIVE MOONS 1-4	77'3"x66'2"	5,111	22'	360	336	-	570	511	28
FIVE MOONS 4-5	77'3"x66'	5,098	22'	360	336	-	570	510	28
FIVE MOONS 5-8	77'3"x66'2"	5,111	22'	360	336	-	570	511	28
FIVE MOONS 6-8	77'3"x33'2"	2,562	22'	180	180	75	285	256	14
FIVE MOONS 1	33'2"x25'9"	854	22'	60	48	27	91	85	-
FIVE MOONS 2	33'2"x25'9"	854	22'	60	48	27	91	85	-
FIVE MOONS 3	33'2"x25'11"	860	22'	60	48	27	91	86	-
FIVE MOONS 4	77'3"x33'	2,549	22'	180	180	75	285	255	14
FIVE MOONS 5	77'3"x33'	2,549	22'	180	180	75	285	255	14
FIVE MOONS 6	33'2"x25'11"	860	22'	60	48	27	91	86	-
FIVE MOONS 7	33'2"x25'9"	854	22'	60	48	27	91	85	-
FIVE MOONS 8	33'2"x25'9"	854	22'	60	48	27	91	85	-
FIVE MOONS PREFUNCTION	-	6,370	16'	-	-	-	-	637	-
NORTH PREFUNCTION	-	9,168	16'	-	-	-	-	917	-
SCISSORTAIL TERRACE PREFUNCTION	86'6"x47'3"	4,087	14'	210	-	-	-	409	-
ROUTE 66	31'x51'8"	1,602	15'	80	90	42	120	160	-
BRICKTOWN	32'x28'6"	912	15'	50	45	27	96	91	-
MYRIAD	32'x27'3"	872	15'	50	45	27	98	87	-
PASEO	34'6"x27'	932	15'	60	54	27	104	93	-
DEEP DEUCE	35'6"x26'9"	950	15'	60	63	30	108	95	-
AUTOMOBILE ALLEY A-C	40'6"x88'8"	3,591	15'	240	216	-	352	359	-
AUTOMOBILE ALLEY A	40'6"x28'2"	1,141	15'	60	63	33	126	114	-
AUTOMOBILE ALLEY B	40'6"x30'	1,215	15'	90	84	33	135	122	-
AUTOMOBILE ALLEY C	40'6"x30'6"	1,235	15'	90	84	33	135	124	-
MISTLETOE	44'x32'9"	1,441	15'	110	96	42	154	144	-
PINON	44'x35'11"	1,580	15'	110	96	42	154	158	-
THUNDER BOARDROOM	25'3"x24'9"	625	15'	-	-	-	-	-	-
LEVEL THREE									
EVENT LAWN AREA	66'x37'	2,442	-	160	-	-	-	244	-
LEVEL 17									
RED EARTH BOARDROOM	37'11"x16'	606	9'	-	-	-	-	-	-

MEETING ROOM CAPACITIES WERE DETERMINED USING 72" ROUNDS OF 10 (ROUNDS CAPACITY), THREE CHAIRS PER 6'X30" TABLE (U-SHAPE CAPACITY) AND THREE CHAIRS PER 6'X18" TABLE (CLASSROOM CAPACITY) ALLOWING FOR MINIMAL AUDIOVISUAL EQUIPMENT.