

MEETING *and* EVENT GUIDE

OMNI LA COSTA RESORT & SPA

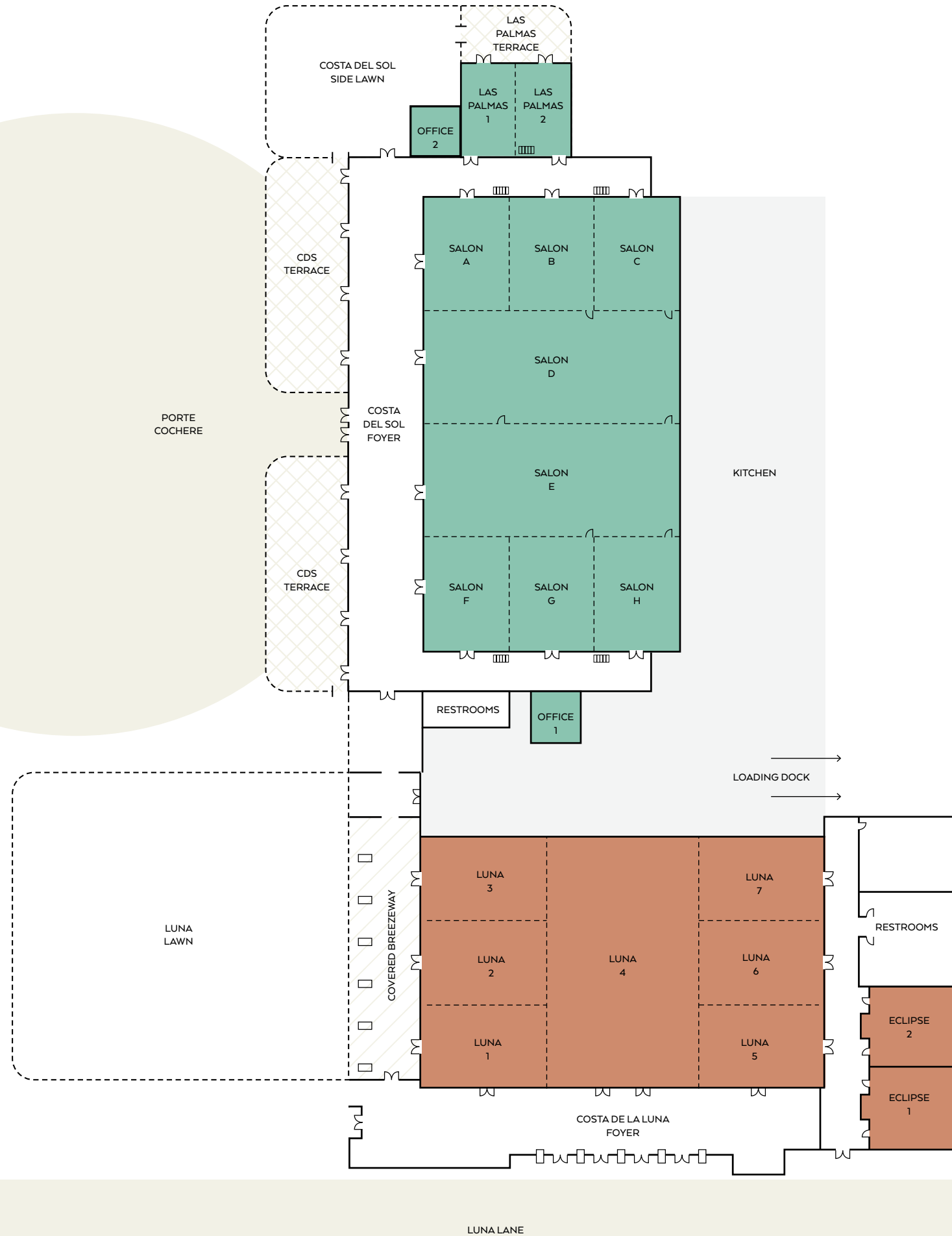

Meeting and Event Venues



Meeting and Event Venues

	SIZE	SQFT (USABLE)	CEILING HT. (USABLE)	RECEPTION	BANQUET	THEATRE	CRESCENT	CLASSROOM	CONFERENCE	U-SHAPE	EXHIBITS 8x10	EXHIBITS 10x10
COSTA DEL SOL BALLROOM	180x100x18	18,000	18'	1,700	1,400	2,900	1,000	1,200	-	-	113	90
SALON A-E OR D-H	135x100x18	13,500	18'	1,350	925	2,300	750	800	-	-	84	68
SALON D & E	90x100x18	9,000	18'	900	675	1,430	450	575	-	-	56	45
SALON A-D OR E-H	90x100x18	9,000	18'	900	675	1,430	450	575	-	-	56	45
SALON D OR E	45x100x18	4,500	18'	450	325	650	250	285	-	-	28	23
SALON A-C OR F-H	45x100x18	4,500	18'	450	325	650	250	285	-	-	28	23
SALON A-B, B-C, G-H OR F-G	45x66x18	2,970	18'	300	215	400	150	180	-	85	19	15
SALON A, B, C, F, G OR H	45x33x18	1,485	18'	150	125	160	60	75	36	42	-	-
COSTA DEL SOL FOYER	28x207x20	5,796	20'	600	300	-	-	-	-	-	26	24
LAS PALMAS	37x42x10	1,554	10'	160	120	160	80	100	40	50	-	-
LAS PALMAS 1 OR 2	37x21x10	777	10'	80	60	90	40	45	20	24	-	-
OFFICE 1	16x16x10	256	10'	-	-	-	-	-	10	-	-	-
OFFICE 2	14x14x10	196	10'	-	-	-	-	-	5	-	-	-

	SIZE	SQFT	CEILING HT. (USABLE)	RECEPTION	BANQUET	THEATRE	CRESCENT	CLASSROOM	CONFERENCE	U-SHAPE	EXHIBITS 8x10	EXHIBITS 10x10
COSTA DE LA LUNA BALLROOM	153x95x17	14,100	17'	1,400	1,100	1,600	720	840	-	-	88	70
LUNA 1-4 OR 4-7	101x95x17	9,449	17'	900	750	1,225	480	550	-	-	59	47
LUNA 4	49x95x17	4,700	17'	450	340	780	225	275	-	-	30	24
LUNA 1-3 OR 5-7	52x95x17	4,700	17'	450	330	600	237	275	-	-	30	24
LUNA 1-2, 2-3, 5-6 OR 6-7	52x63x17	3,100	17'	275	200	400	160	180	60	80	16	14
LUNA 1, 2, 3, 5, 6 OR 7	52x30x17	1,560	17'	150	110	200	80	90	37	45	10	8
LUNA FOYER	28x207x20	4,445	20'	450	325	-	-	-	-	-	16	14
ECLIPSE 1 OR 2	29x34x17	1,073	17'	100	85	100	35	40	25	25	-	-



Meeting and Event Venues

COASTAL EVENTS CENTER EAST LOWER

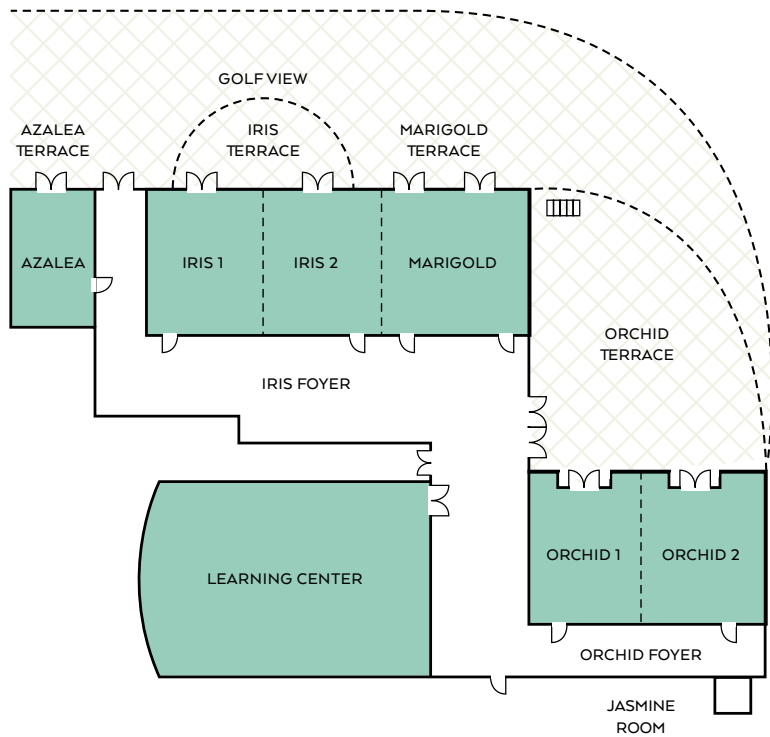

COASTAL EVENTS CENTER EAST & WEST UPPER

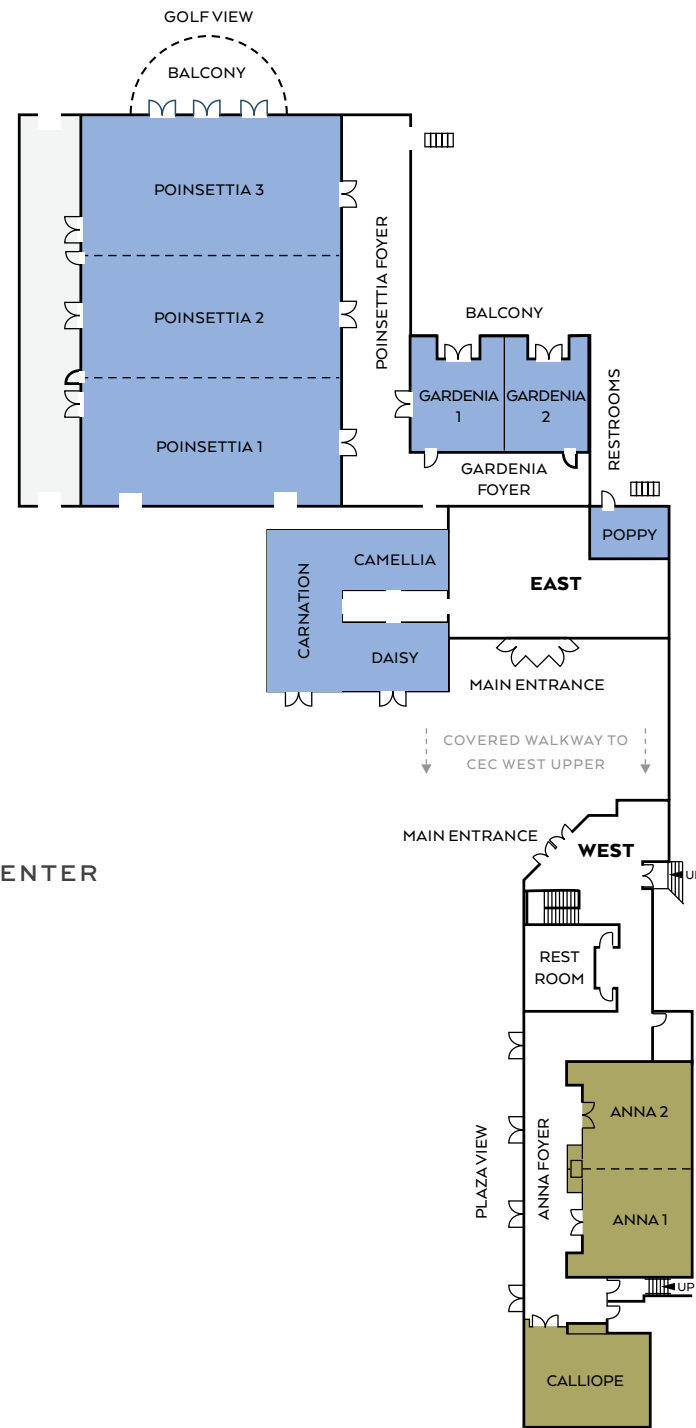

CLUBHOUSE

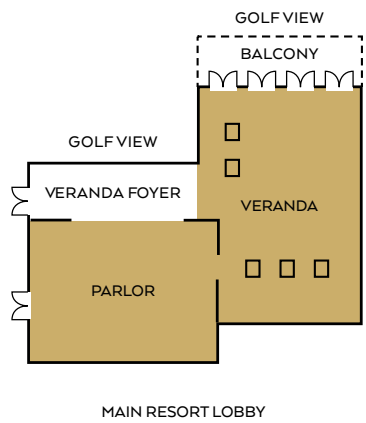

COASTAL EVENTS CENTER WEST LOWER

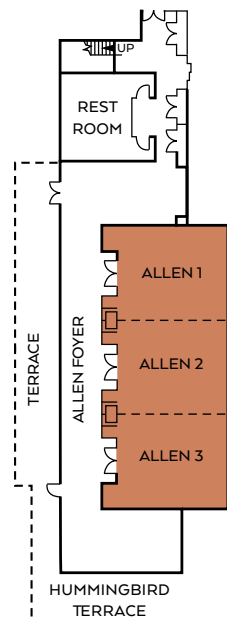

Meeting and Event Venues

	SIZE	SQ. FT.	CEILING HEIGHT	RECEPTION	BANQUET	THEATRE	CRESCENT	CLASSROOM	CONFERENCE	U-SHAPE	EXHIBITS 8x10	EXHIBITS 10x10
COASTAL EVENTS CENTER - EAST LOWER												
LEARNING CENTER	-	1,700	10'	-	-	-	-	70	-	-	-	-
IRIS	52x33x10	1,716	10'	160	145	175	100	50	40	45	-	-
IRIS 1 OR 2	26x33x10	858	10'	80	72	90	30	40	24	30	-	-
ORCHID	51x27x10	1,377	10'	120	140	160	60	88	35	40	-	-
ORCHID 1 OR 2	25x27x10	675	10'	65	50	60	25	27	20	24	-	-
MARIGOLD	30x29x10	870	10'	100	60	100	30	50	18	24	-	-
AZALEA	19x24x10	456	10'	-	-	-	-	-	16	-	-	-
JASMINE	9x7x10	54	10'	-	-	-	-	-	-	-	-	-
COASTAL EVENTS CENTER - WEST LOWER												
ALLEN	26x69x9.5'	1,700	10'	155	120	170	90	65	37	44	-	-
ALLEN 1 & 2, OR 2 & 3	26x46x9.5'	1,100	10'	104	80	126	60	44	24	30	-	-
ALLEN 1, 2, OR 3	26x23x9.5'	550	10'	52	40	63	30	22	12	15	-	-
ALLEN FOYER	99'x30 + 35x16	1,500	10'	150	125	-	-	-	-	-	-	-

	SIZE	SQ. FT.	CEILING HEIGHT	RECEPTION	BANQUET	THEATRE	CRESCENT	CLASSROOM	CONFERENCE	U-SHAPE	EXHIBITS 8x10	EXHIBITS 10x10
CLUBHOUSE												
PARLOR	66x36x10	2,376	10'	220	200	250	130	130	45	50	15	12
VERANDA	57x83x10	2,950	10'	400	240	350	160	160	45	50	18	15
VERANDA FOYER	66x15x10	1,000	10'	-	-	-	-	-	-	-	-	-

	SIZE	SQ. FT.	CEILING HEIGHT	RECEPTION	BANQUET	THEATRE	CRESCENT	CLASSROOM	CONFERENCE	U-SHAPE	EXHIBITS 8x10	EXHIBITS 10x10
COASTAL EVENTS CENTER - EAST UPPER												
POINSETTIA BALLROOM	110x74x14	8,140	14'	800	540	1,000	420	500	-	-	51	41
POINSETTIA 1, 2 OR 3	34x74x14	2,664	14'	200	170	320	140	135	-	60	17	13
POINSETTIA 1 & 2, OR 2 & 3	68x74x14	5,328	14'	400	340	700	280	290	-	100	33	27
POINSETTIA FOYER	98x20x10	1,960	10'	275	-	-	-	-	-	-	-	-
GARDENIA	52x24x10	1,326	10'	120	95	120	72	88	35	40	-	-
GARDENIA 1 OR 2	25x26x10	650	10'	60	60	80	40	40	20	24	-	-
CARNATION	34x20x10	680	10'	45	30	64	35	30	20	20	-	-
CAMELLIA	32x18x10	576	10'	30	30	50	28	20	20	20	-	-
DAISY	32x18x10	576	10'	-	-	-	-	-	16	-	-	-
POPPY	18.5x13.5x10	250	10'	-	-	24	-	-	16	-	-	-
COASTAL EVENTS CENTER - WEST UPPER												
ANNA	26x52x10	1,350	10'	114	95	127	66	47	27	33	51	41
ANNA 1 OR 2	26x26x10	650	10'	57	47	63	33	23	14	18	17	13
CALLIOPE	31x22x10	675	10'	64	53	70	37	27	15	16	33	27
ANNA FOYER	74x31 + 49x29	1,917	10'	108	90	-	-	-	-	-	-	-

Outdoor Event Space

	SQ. FT.	RECEPTION	BANQUET
OUTDOOR			
COSTA DEL SOL TERRACES	3,072	250	240
COSTA DEL SOL SIDE LAWN	3,015	500	360
LAS PALMAS TERRACE	855	50	48
COSTA DE LA LUNA TERRACE	1,600	175	80
LUNA LANE	4,000	400	400
LUNA LAWN	10,000	1,200	640
VILLA COURTYARD	2,500	100	50
MAIN PLAZA	9,500	800	540
SNOW-IN-SUMMER LANE	2,500	250	150
HUMMINGBIRD TERRACE	1,000	60	
VISTA TERRACE	9,500	800	600
ORCHID TERRACE	4,150	300	250
IRIS TERRACE	2,700	275	180
MARIGOLD TERRACE	1,350	135	90
AZALEA TERRACE	1,300	60	40
RANGE VIEW COURT	11,400	850	700
RANGE VIEW LAWNS (UPPER & LOWER)	30,000	425	350
THE BACKYARD	10,575	1,000	600
LEGENDS LAWN	1,575	150	96
VALLEY PROMENADE	2,625	400	220
EDGE POOL	3,975	275	140
POOL AREAS			
VILLA POOL	5,472	120	80
GARDEN POOL	10,472	720	500
EDGE POOL	3,975	200	140



About Omni La Costa Resort & Spa



A STORIED LANDMARK WELCOMES A NEW ERA

The iconic Omni La Costa Resort & Spa is excited to debut reimagined guestrooms, spa and golf facilities, and meeting spaces in 2024. Nestled among aong 400 lush garden acres near pristine beaches and recognized as one of the world's top spa and golf destinations, the resort's latest enhancements evolve its overall aesthetic and famed reputation, marking the beginning of a new era for meetings and events.

HIGHLIGHTS INCLUDE

- A renovation of over 500 guestrooms, including villas, suites, hospitality rooms and Presidential Suites. The new design blends history with modernity, enhancing the resort's beloved Spanish architecture with light airy spaces, soft coastal textures, and neutral tones.
- A dramatic redesign of the Champions or "North Course" by renowned architect Gil Hanse, paving the way for three consecutive NCAA Division I Championships.
- A refresh of the award-winning Spa at La Costa, including stunning upgrades to the salon, relaxation lounges, locker rooms and treatment rooms.

AMENITIES

- Award-winning spa and salon with 42 treatment rooms
- Ranked as one of the Top 100 Golf Resorts in North America by Golf Magazine, featuring two championship courses and the Golf Performance Institute
- World-class tennis program by Cliff Drysdale Tennis with 17 clay and hard tennis courts
- 9,100 square foot Athletic Club
- Yoga, pilates, meditation and other exercise classes
- Eight sparkling pools including family-friendly Splash Landing with waterslides and adults-only Edge Pool
- Kidtopia Kids Club and family game lounge
- Locally-sourced cuisine via five dining outlets, including Bob's Steak & Chop House, VUE and Bar Traza
- Eight boutiques
- Premier Fitness Camp

VENUE HIGHLIGHTS

- 45 meeting rooms, including 18,000-square-foot Costa Del Sol Ballroom and the 14,000-square-foot Costa de la Luna Ballroom
- 76,000 square feet of indoor event space and an additional 100,000 square feet of outdoor space
- Over 16 meeting rooms with natural light

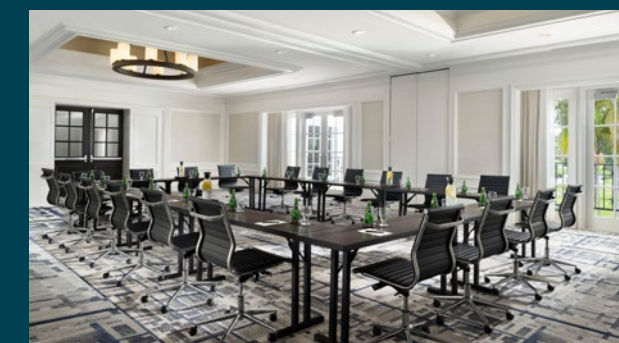

Omni La Costa Resort & Spa Property Map

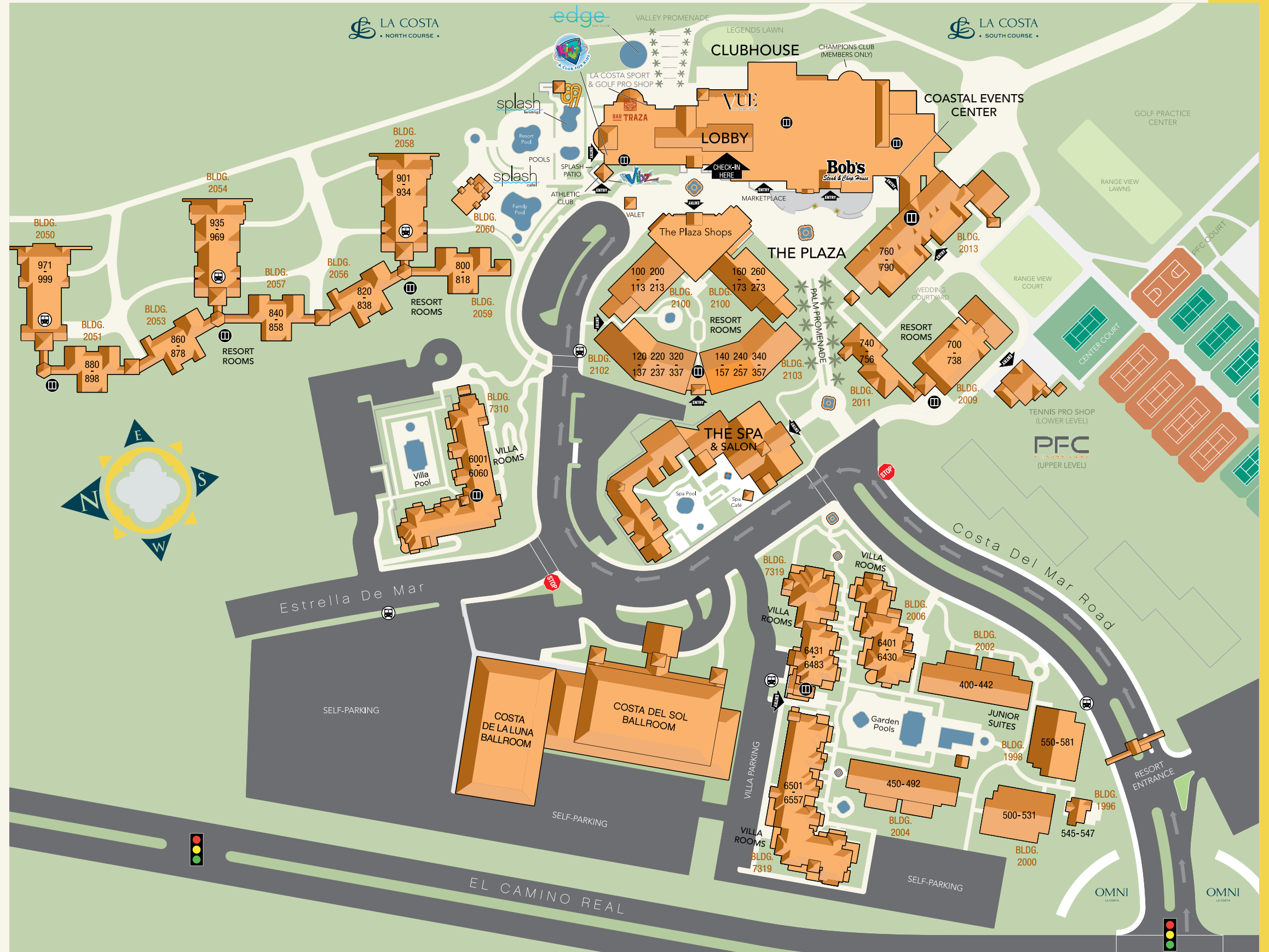

Golf at La Costa



Omni La Costa Resort & Spa offers 36 spectacular holes of golf on two highly acclaimed championship courses. Stunningly beautiful, yet equally challenging to conquer, each course offers a distinct set of thrilling experiences, moments and settings.

NORTH COURSE

The former Champions Course has undergone significant design changes as it prepared to host the NCAA Division I Golf Championships. Acclaimed architect Gil Hanse has implemented more risk-rewards decisions to challenge players and has drawn inspiration from classic Southern California courses, as aesthetics were tweaked to give the North Course a more proper sense of scale and place. Hanse Golf Course Design has created more than 26 original designs and provided restorations for 40 of the world's most renowned clubs.



SOUTH COURSE

With an iconic history and list of who's who having played here, the former Legends Course is a true classic and a gem of traditional design. Combined with recent renovations and modern touches for improved playability, the open concept and visually appealing backdrops and features holds South Course in the highest regard by all who have played on its greens.

PRACTICE RANGE

Led by Beau Welling Design, the resort's practice facility has been elevated with a newly lengthened driving range and expanded short game area. Like the golf course project, these upgrades incorporate a new state-of-the-art irrigation system that allows the facility to maintain efficient usage of water for sustainability considerations while still exhibiting the highest maintenance standards.

AWARDS

- Golf Magazine, Southern California's Gold Medal Resort
- Golf Digest, #1 Family Golf Destination in the Country
- Golfweek, Golfweek's Best: Next 100 Resort Courses
- Corporate & Incentive Travel, Greens of Distinction Award

The Spa at La Costa

A REIMAGINED RETREAT FOR THE SOUL

Upscale travelers and wellness seekers have chosen The Spa at La Costa to relax and recharge since 1965 when the resort was known as the "original destination for mind, body and sport." Our reimagination carries this tradition forward, offering guests an upscale, true whole-body wellness experience.

Honored by industry accolades, The Spa at La Costa continues to strengthen our commitment to quality by providing luxurious spa experiences, utilizing innovative techniques, organic ingredients and sustainable products.

Cater to your palate with healthy and refreshing options at our serene garden café. Relax poolside with the sun overhead while sipping a signature Bellini, relieve stress underneath one of the Roman waterfall showers or walk barefoot on Southern California's only reflexology pathway.

Whether you're looking for solitude or the perfect venue for your special occasion, The Spa at La Costa offers an inspiring and tranquil environment for all.

AWARDS

- Discover SD, Top Luxury Resort Spa in San Diego
- Condé Nast Traveler, Reader's Choice Awards: Top 100 Resort Spas in the U.S.
- San Diego Magazine, Best Hotel Spa
- Fine Magazine, San Diego's Best Spas
- Smart Meetings, Best Hotel Spa
- American Spa, Best Resort Spa list
- U.S. News & World Report, Top Wellness Retreat Around the Globe



Put an end *to*
BUSINESS AS USUAL.



OMNI

LA COSTA

2100 COSTA DEL MAR ROAD | CARLSBAD, CALIFORNIA 92009 | 800-854-5000
OMNIHOTELS.COM/LACOSTA