

OMNI SAN FRANCISCO HOTEL MEETING SPACE

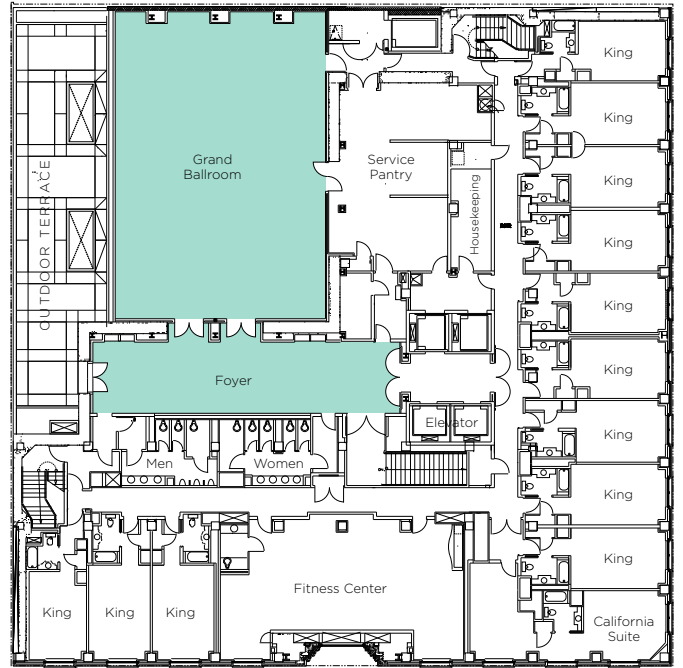
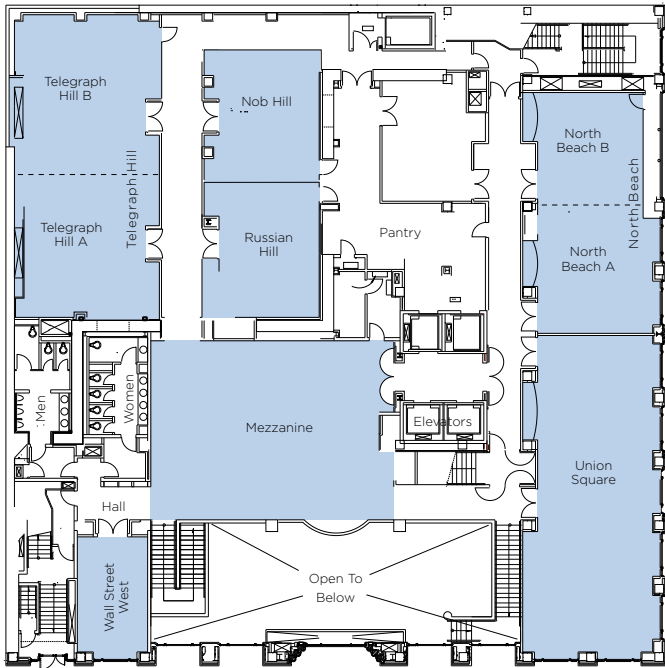

OMNI SAN FRANCISCO HOTEL MEETING ROOM CAPACITY

	SQUARE FOOTAGE	DIMENSIONS	CEILING HEIGHT	FLOOR COVERING	PORTABLE WALLS	THEATER	CLASSROOM 18"	BANQUET 60"	BANQUET 72"	RECEPTION	HOLLOW SQUARE	EXHIBITS 8' X 10'	CONFERENCE	U-SHAPE
THIRD FLOOR														
GRAND BALLROOM	2,800	44' x 63'8"	15'	CARPET	NO	320	180	190	228	300	70	17	60	70
FOYER	960	64' x 15'	9'	CARPET	—	—	—	—	—	80	—	—	—	—
SECOND FLOOR														
MEZZANINE	1,500	50' x 30'	9'6"	CARPET	—	—	—	110	120	175	—	9	—	—
TELEGRAPH HILL	1,827	29' x 63'	9'	CARPET	YES	120	100	130	120	190	60	11	50	48
TELEGRAPH HILL A	812	29' x 28'	9'	CARPET	YES	50	40	50	48	45	30	—	24	24
TELEGRAPH HILL B	1,015	29' x 35'	9'	CARPET	YES	60	56	60	48	60	36	—	34	30
NOB HILL	679	22'6" x 30'	9'	CARPET	NO	50	32	50	48	50	30	—	20	24
RUSSIAN HILL	679	22'6" x 30'	9'	CARPET	NO	50	32	50	48	50	30	—	20	24
NORTH BEACH	1,196	23' x 52'	9'	CARPET	YES	100	70	90	96	100	54	—	46	48
NORTH BEACH A	624	24' x 26'	9'	CARPET	YES	45	40	60	48	50	24	—	20	18
NORTH BEACH B	572	22' x 26'	9'	CARPET	YES	45	38	50	48	45	30	—	20	24
UNION SQUARE	1,632	24' x 68'	9'	CARPET	NO	150	80	130	132	150	54	10	54	46
WALL STREET WEST	335	14' x 24'	9'6"	CARPET	—	—	—	—	—	—	—	—	12	—